



## Vertical Blind Collection

## Fitting & Care Instructions

# Fitting your Blind

**Important:** brackets should be fixed a sufficient distance from the window to allow the vanes to clear window handles or other obstructions.

## Brackets

Identify type of bracket supplied.

### Snap In Top Fix (A):

For fixing to a horizontal surface.

### Rigid Top Fix (B):

For fixing to a horizontal surface.

### Face Fix (C):

For fixing to a vertical surface.

### Shallow Face Fix (D):

For fixing to a vertical surface.

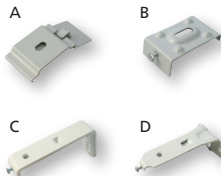

An appropriate number of brackets are supplied for width.

Brackets should be positioned 100mm (4") from each end of the headrail. Additional brackets are supplied for blinds wider than 1400mm (55") and should be screw fixed evenly across the width of the blind. Maximum spacing between brackets should be 1200mm (47").

Determine headrail position as shown in diagram opposite, ensuring that when the blind is fitted window handles will not obstruct it.

Position brackets and screw fit.

### Fixing into wood:

No.8 x 19mm ( $\frac{3}{4}$ ") flange head screws are recommended.

### Concrete, brick, plaster, etc.

Use Masonry plugs and screws of an appropriate length, e.g. No.8 x 32mm ( $1\frac{1}{4}$ ") flange head screws to obtain a secure fixing.

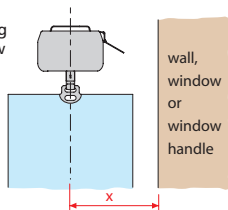

x = 75mm (3"), 127mm (5") vanes

x = 57mm ( $2\frac{1}{4}$ "), 89mm ( $3\frac{1}{2}$ ") vanes

## Fitting

### Snap In Top Fix (A):

Slot the front lip of the headrail over the leading edge of the bracket and snap upwards securely into position.

### Rigid Top Fix (B):

Slot the front lip of the headrail over the locating tang of the bracket, push upwards and tighten screw to secure (be careful not to over tighten).

### Face Fix (C) & Shallow Face Fix (D):

Slot the back lip of the headrail over the locating tang of the bracket, push upwards and tighten screw to secure (be careful not to over tighten).

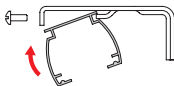
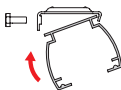
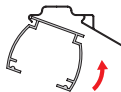

## Attaching the Vanes

With the control in the open position, slip the hanger up and into the traveller hook as shown. Use the 1st or 2nd position as desired.

### Stabilising Chain

Present each clip to the weight post at a 45 degree angle as shown and push securely onto the post.

Note: if installing blinds with a split draw, cut chain at the centre parting point.

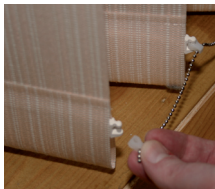
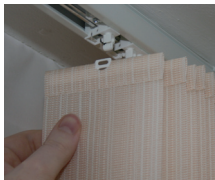

# Operating your Blind



Use pull cord to open and close your blind. Use the operating chain to rotate the vanes. Only traverse the vanes with the blind in the open position.

Always use the cord cleat and chain safety clip to remove the possibility of loose hanging loops.



## Caring for your Blind

### Headrail

The headrail mechanism is self-lubricating. Occasionally spraying with silicone based fluid such as a proprietary brand of furniture polish will maintain easy operation.

### The Vanes

Fabrics are specially coated to ensure that the vanes will hang straight, repel dust and not fray. The coating may react to hot water, strong detergents and bleaching agents.

To care for the vanes, vacuum occasionally in the same way as you would with curtains or upholstery. Dirty marks may be removed by wiping with a lightly moistened cloth, using mild detergent/warm water mix.

If your vertical blind fabric is washable please refer to the separate washing instructions you will have received with your blind. If in any doubt, consult your supplier.